

NOTICE: WHEN GOVERNMENT DRAWINGS, SPECIFICATIONS, OR OTHER DATA ARE USED FOR ANY PURPOSE OTHER THAN IN CONNECTION WITH A DEFINITELY RELATED GOVERNMENT PROCUREMENT OPERATION, THE UNITED STATES GOVERNMENT THEREBY INCURS NO RESPONSIBILITY NOR ANY OBLIGATION WHATSOEVER, AND THE FACT THAT THE GOVERNMENT MAY HAVE FORMULATED, PROVIDED, OR IN ANY WAY SUPPLIED THE SAID DRAWINGS, SPECIFICATIONS, OR OTHER DATA IS NOT TO BE REGARDED BY APPLICATION OR OTHERWISE AS IN ANY MANNER LICENSES THE HOLDER OR ANY OTHER PERSON OR CORPORATION, OR CONVEYING ANY RIGHTS OR PERMISSION TO MANUFACTURE, USE, OR SELL ANY PATENTED INVENTION THAT MAY IN ANY WAY BE RELATED THERETO.

THIS DOCUMENT HAS BEEN PURCHASED BY THE GOVERNMENT AND MAY BE REPRODUCED AND USED IN CONNECTION WITH ANY GOVERNMENT PROCUREMENT OR MAINTENANCE OPERATION.

\* FOR INFORMATION ONLY. CONTRACTOR MAY AT HIS OPTION DEVIATE FROM THESE PROCESS DETAILS.

**X SWE APPROVAL**  
SYM PR10042-12

REVISIONS			
SYM	DESCRIPTION	DATE	APPROVAL
A.	A. ADD WORD "INSIDE" TO .938 & 1.688 DIMS	17 NOV 59	42428-PC 59-A1-51 REV'D PME

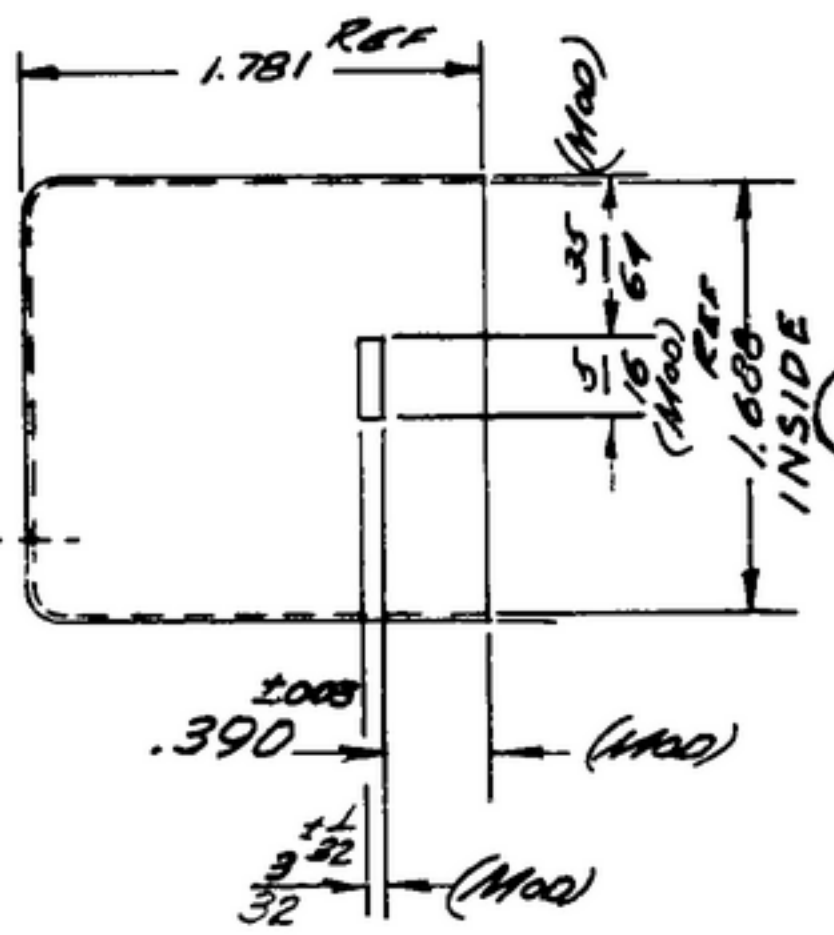
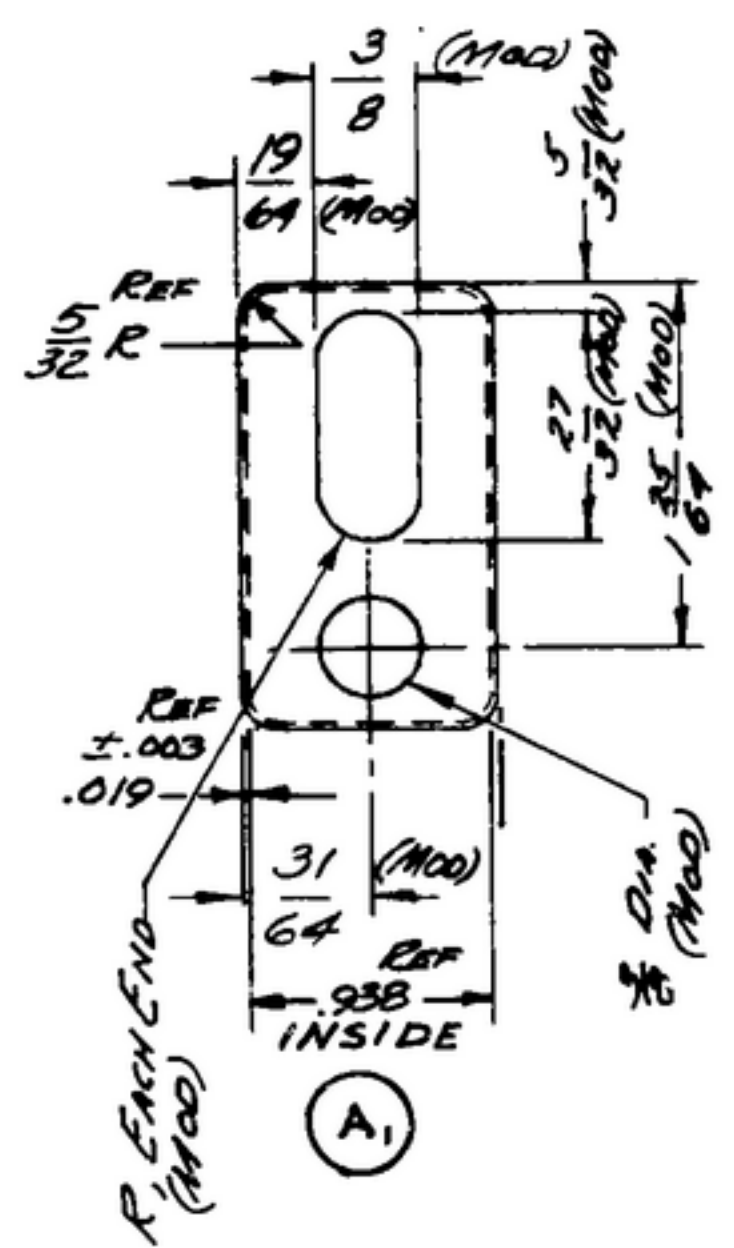
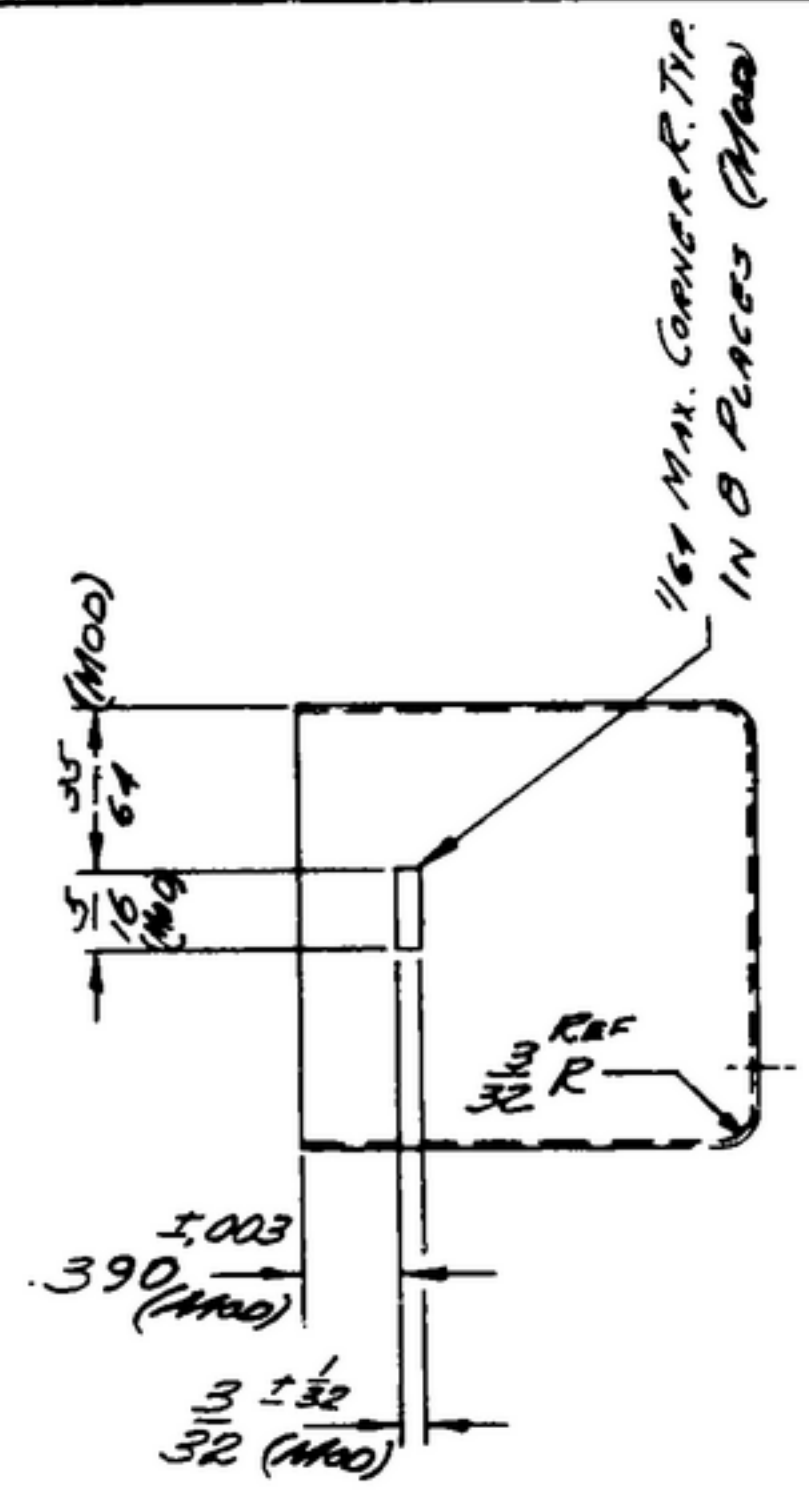

NOTES:  
1. PART MAY BE AS SUPPLIED BY PAUL & BERKMAN, INC., PHILADELPHIA, PA., OR EQUAL, MODIFIED AS SHOWN & AS INDICATED BY FINISH.  
PART NO. 15-938-1688

A1 MATERIAL: DRAWN ALUMINUM  
FINISH: E513 PER SPEC MIL-F-14072  
\* COLLINS 580 0036 00

PROCESS PART NO.	ITEM	QTY	PART NO.	DESCRIPTION	MATL	MATL SPEC	NOTES
<del>141 0401 00</del>		1		CAN SHIELD			

LIST OF MATERIAL COLLINS PART NO. 558 0405 002

COLLINS NO.	QTY	NEXT ASSY	USED ON
558 0515 002	1	SM-B-249162	
558 0514 002	1	SM-B-249161	
558 0513 002	1	SM-B-249160	
558 0512 002	1	SM-B-249159	
558 0511 002	1	SM-B-249158	
558 0510 002	1	SM-B-249157	SC-DL-248775

DRAWN HENRY  
CHECKED *Plan*  
APPROVED \_\_\_\_\_

UNLESS OTHERWISE SPECIFIED:  
DECIMAL DIMENSIONS INCLUDING HOLE SIZES MAY VARY ±.005  
FRACTIONAL DIMENSIONS INCLUDING HOLE SIZES MAY VARY ±1/64  
MACHINED ANGLES MAY VARY ±.1°  
SHEARED ANGLES MAY VARY ±.25°  
BROKEN ANGLES MAY VARY ±.1°  
ECCENTRICITY BETWEEN ANY DIAMETERS ON THE SAME CENTERLINE SHALL NOT EXCEED .010 TOTAL INDICATOR READING.  
ALL DIMENSIONS ARE FINISH DIMENSIONS INCLUDING APPLIED FINISH AND ARE GIVEN IN INCHES.

COLLINS-RADIO CO.  
14214-P.H  
51-93  
SIGNAL CORPS  
REVIEWED PME  
APPROVED HLY  
PME  
DATE 15 DEC 55

CAN-SHIELD

DEPARTMENT OF THE ARMY  
SIGNAL CORPS ENGINEERING  
LABORATORIES  
FORT MONMOUTH NEW JERSEY  
SM-B-249054